

# Long Distance RC Surfcasting Bait Boat Instruction Manual

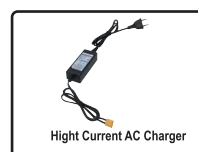

MODEL NO.:3251V2  
DIMENSION:850x205x230mm  
WEIGHT: 3.9 kg

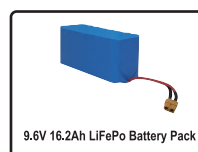
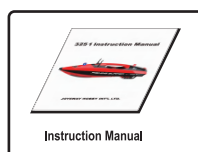

## Important Safety Note

1. This boat is not a toy, It is not intended for persons under 14 years of age.
2. Always take the boat batteries out of the boat while transporting the boat.
3. The boat and transmitter batteries should be stored outside the boat and transmitter.
4. Never overcharge the batteries, Switch charger off when red light on charger turns green.
5. Never leave boat and batteries in direct sunlight as this cause the boat and batteries to become very hot.
6. In periods of inactivity ensure the batteries are disconnected from the boat and transmitter batteries are not left in the transmitter.
7. DO NOT leave wet particles inside the boat.
8. DO NOT use non-original chargers to charge the battery.
9. DO NOT use the product where there are many people swimming.
10. DO NOT use the boat in the water where are many obstacles and water plants.
11. DO NOT make power battery touch products with sharp edges to avoid damage and short circuit.
12. DO NOT store and charge the battery under the environment of high temperature or high humidity.
13. DO NOT operate the boat when in storm and thunder weather, As wireless remote control is extremely dangerous in such weather conditions.
14. DO NOT operate the boat where there are radio towers and high voltage substations, such circumstance will badly affect the GPS and radio signal.
15. Wash body including body metal parts of the RC boat by freshwater after use.
16. If the boat has problem in the water, people shall not swim to get the boat back.

## Transmitter Battery Instruction



Open battery cover

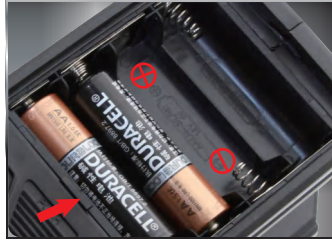

Put in 4 AA battery, close the cover ,notice correct polarity



Switch on power, TX LED light on.  
Note: Switch on Transmitter firstly before connect power battery with boat.

## Power Battery Charging

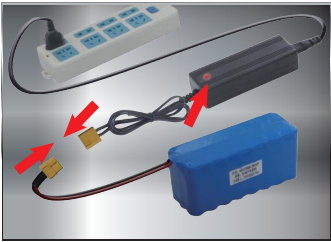

Use charger to connect power outlet, connect battery with charger

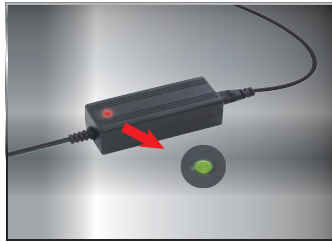

The light of the charger turns solid on to indicate charging. The light will turn green after fully charged.

### WARNING:

**DO NOT** leave battery on charge overnight.  
**DO NOT** leave battery unattended during charging.  
**DO NOT** charge battery when battery is inside boat.  
**DO NOT** leave battery plugged into the charger any longer than 6 hours maximum.  
It takes around 4~5 hours to fully charge battery, Disconnect battery with charger after green light is solid on.

### NOTE:

- 1) Fully manual driving, around 14 times bait release per battery charge within 200 meters range.
- 2) Fully manual driving, around 45 mins continuously driving per battery charge.
- 3) If combine with GPS autopilot driving, will increase the total driving time and bait release times.

## Put The Power Battery Inside Boat



Open boat cover



Put battery inside, fix it with velcro strap. Use battery plug to plug in receiver power connector, the light on the receiver turns on ( remarks: The transmitter shall switch on before receiver switch on), then the control system is working.

## Basic Control Operation



Pull the trigger back, the boat moves forward; push the trigger forward, the boat moves backward; rotate the wheel anti-clockwise, the boat turns left, rotate the wheel clockwise, the boat turns right.



Press the "LED" button one time, the night navigation light turns on, press the button again, the night navigation light turns off.



If boat steer to right without steering input, press ST/L button to adjust boat run straightly.  
If boat steer to left without steering input, press ST/R button to adjust boat run straightly.

## Transmitter & Receiver BIND

Switch on transmitter, connect power battery with boat, if "RX" and "BATT.INDICATOR" lights don't turn on, this means you need to bind the transmitter with the receiver. Follow below procedures to bind transmitter and receiver.



Firstly Make sure transmitter is power off, battery don't connect with boat. Secondly press ST/L button and hold, Switch on transmitter, TX light solid on, when GPS ON light flash, let go ST/L button.



Connect battery with boat, when "RX" and "BATT.INDICATOR" lights turn on, now you have bind the transmitter and receiver.

## Open Bait Hopper And Rear/Bottom Lock



When the transmitter and boat are both power on, rotate the knob on the transmitter to C, the lock pins at the rear and bottom both withdraw into the lock. This means all lock are opened status.



Rotate the knob on the transmitter to B, the lock pins at the bottom and rear will extend to the end of the lock. The bottom and rear lock are now locked.



Rotate the knob on transmitter to A, the pin of the rear lock will extend out of the lock, then press the hopper cover down to close the hopper.



Rotate the knob on transmitter from A to B, the lock pin at the rear and bottom will withdraw to align with the lock, opening the rear hopper door. Rotate the knob from B to C, the lock pin at both rear and bottom will withdraw from the end of the lock to inside of the lock, releasing the hook and bait at the rear hopper and bottom.

## GPS Autopilot Function

### About Start Of GPS Function



When transmitter and boat are both powered on



The TX red light and RX green light are both turn on.( Indicate the transmitter and boat are working)



Wait for GPS ON green light start to flash. (Remarks: It takes about 3 - 5 minutes based on circumstances) which indicates the GPS mode on receiver starts working.

# Original Point Set Up & One Button Return Function

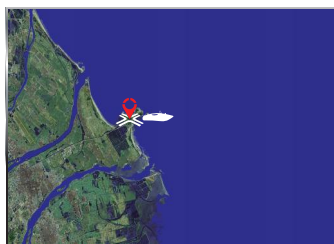

Before you put boat in water, find a location Near the shore, This location to be the original point that you need to set up.

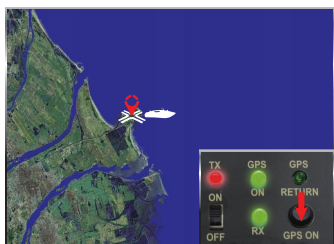

Press the button GPS ON on transmitter over 5 seconds. Green light GPS ON from flash to be solid on, original point is memorized, it is also the home point.

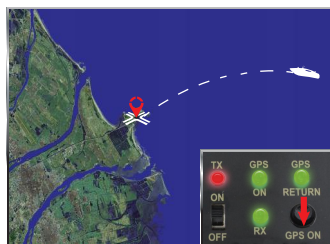

After the boat driven to some distance, Press button GPS ON over 1 second, GPS RETURN green light is solid on, the boat will return back to the original point automatically. When arrive at original point, you will hear a beep sound on TX, GPS RETURN light will be off.

NOTE: The big wave in ocean will affect the autopilot driving, when boat autopilot Driven to near shore, suggest to control the boat manually back to shore

Control Priority: When the boat is under the status of one button return automatically, as long as we pull or push the trigger or rotate the wheel, the boat will cancel return automatically and turn to be controlled by human. Once again if you want to start return automatically, you need to press button GPS ON for 1 second again. then the boat will return automatically.

## Fail-Safe Function

When boat is out of control range or you can't see the boat in ocean. You can switch off the transmitter power, After 30 seconds, the Fail-Safe function activated, boat is autopilot driven to original point where you setup. When you can see the boat or boat is within the control range, switch on transmitter, control boat back to shore.

## Four Spots Marking Function

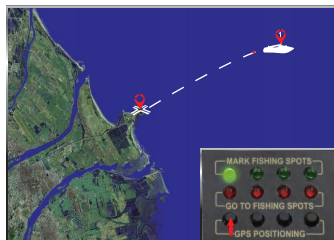

After the RC boat driven to a location where you want to mark as first fishing spot, press any one of the 4 GPS POSITIONING button over 5 seconds, the green light will be solid on (now you have set up first fishing spot)



If you want boat gets back to the marked fishing spot, Press GPS POSITIONING button over 1 second, relevant red light will be solid on, boat go to marked fishing spot by GPS autopilot.



When the boat arrive at the spot by GPS autopilot, boat stop, the red light will be off and transmitter will make beep sound to indicate boat has arrived to the marked fishing spot.



You can set up 4 different fishing spots by pressing the corresponding GPS POSITIONING button over 5 seconds.

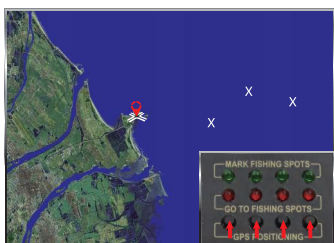

If you want to cancel a marked spot, press corresponding button over 5 seconds. Then the green light turn off to show that the fishing spot is canceled.

NOTE: If you are fishing in a new location, you need to cancel all the marked fishing spots and original point where you previously setup in last Fishing location.

## Low Voltage Warning Function Of Power Battery



When transmitter and RC boat are both power on, the four green lights on the transmitter turn on.



When the power of the battery is running low, the 4 green lights will flash, transmitter will make sound and front and rear navigation light will flash to remind you need to drive the boat back and recharge battery.

NOTE: when BATT INDICATOR lights flash, boat battery will have some power to let you drive boat at least 500 meters.

## Important Usage Tips



1. Before you put the bait in the hopper door, firstly switch on transmitter, then connect power battery with boat receiver. On transmitter, rotate the "RELEASE" knob to C position. This means all the lock pin and hopper door are open status.



2. Attach a metal ring on fishing line where the distance between metal ring and hook is maximum 15cm, attach the metal ring with the boat rear lock pin, rotate the "RELEASE" knob to A position. This arrangement will ensure the tensile force on the rear lock rather than on rear hopper door while boat take the line out



3. Open the rear hopper door, put the bait and hook inside, rear lock pin is now extended out from lock because the "RELEASE" knob is at A position. Press down the hopper cover to attach with lock pin, until you hear click sound, now the hopper door is closed.

## Surfing Tip



4. On transmitter, rotate the "RELEASE" knob from A to B, hopper door open, from B to C, boat rear lock pin open, now the bait and hook will be released after the fishing line is pulled straightly.



5. If you use a larger size bait that can't be put inside hopper door, you can attach the metal ring with the boat bottom lock pin, on transmitter, rotate the "RELEASE" knob to C position, the boat bottom lock pin open, the larger size bait and hook will be released.



6. When you drive the boat out on the beach, It is better to drive the boat against the wave direction.

7. Setting up the original point is very critical and the basic of GPS one button return and fail-safe function. Before you use your boat to delivery bait, you should firstly set up the original point, Refer to manual Page 3 for the correct set up. Neglect of doing this, this boat can't achieve the GPS one button return and fail-safe function.

8. The transmitter is not waterproof, keep your transmitter away from water, Otherwise, you will lost control of the boat.

9. When you drive the boat with transmitter, you should keep the transmitter at over 1 meter height to the water surface, This will ensure better radio range and receiving signal. If possible, the higher the better.

10. The transmitter range is 500 meters (depend on weather and circumstance), Transmitter and receiver are bidirectional transmission, the receiver transmission range is 300 meters (depend on weather and circumstance), when boat out of 300 meters range with transmitter, The LED lights on transmitter "BATT.INDICATOR" and GPS autopilot function lights will likely to be flashing or turn off.

When you hold your transmitter up in a higher location, you can improve the receiver transmission range and LED lights might be turn on again. (NOTE: the transmitter is still working properly with boat within 500 meters radio range)

## Radio Hanger



Triangle radio hanger, hook radio hanger and 3pcs screw are included in tool bag, use these to hang radio on your neck with ribbon or attach radio with fishing support tube on filed.

## AFTER USE

1. After boat back to shore, before open hatch cover, use dry cloth to dry if any water trapped on the hatch cover. This is to prevent water drop inside the cabin when you open the hatch cover.
2. Make sure your hands are dry before you connect or disconnect boat battery connectors. Wet hands may cause battery connectors rusted due to salt water.
3. If small amount of water founded inside the cabin due to water drop when you open hatch cover. Lean the boat hull and use dry tissue to dry the water.
4. After each fishing trip, cover well the hatch cover to be lock, flush the whole boat hull and metal parts with fresh water. Especially the two water inlet pipe located at the propeller cover. This will prevent the metal parts rusted by salt water. Use dry cloth to dry water on the hull surface. Open the hatch, let air dry and the moisture is evaporated.



## Rig setup for large fish suggestion

If you intend to fishing large fish with heave bait, we suggest you can try below rig setup and attach to the fishing surfer boat's bottom and rear lock. This rig setup and attachment have below advantages:

- 1) Boat can better drag the heavy bait and weight out to the ocean. Won't affect boat surfing big wave and driving function.
- 2) Line length 12 inches between bottom lock and rear lock, this line length won't tangle with propellers.

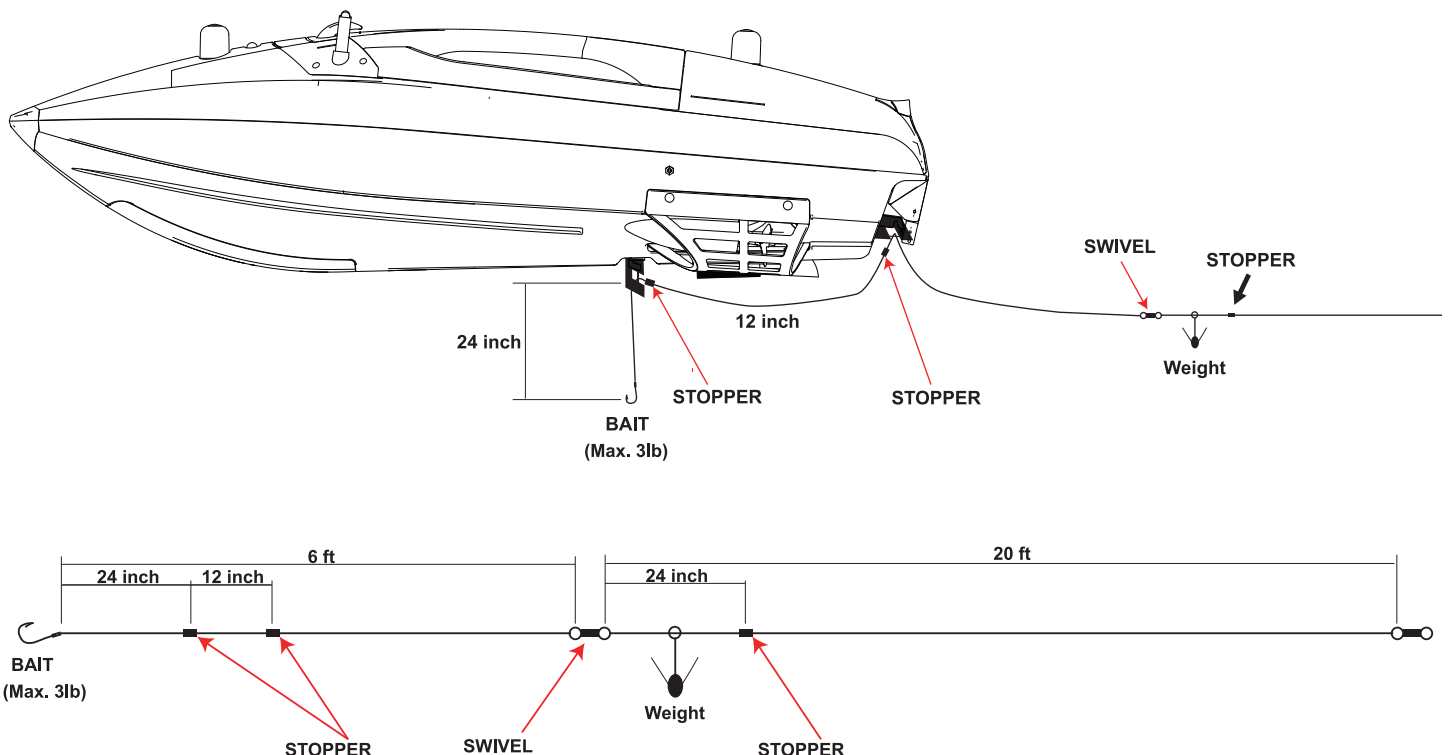

## **TROUBLESHOOTING**

If you have replaced with new transmitter, receiver, motor, or radio can't control boat properly. You need to follow below procedures to calibrate radio, setup radio new ID and rebind the radio with boat. And calibrate the electronic speed controller (ESC).

### **Radio Calibrate**

- 1) Radio and boat are power off status.
- 2) Press "ST/R" and "GPS ON" buttons and hold.
- 3) Switch on radio power, "BATT.INDICATOR", "GPS ON", "GPS RETURN" lights are all solid on. After 5 seconds, release step 2) buttons. Switch off radio power.

### **Radio New ID Setup**

- 1) Radio and boat are power off status.
- 2) Press "ST/R" button and hold.
- 3) Switch on radio power, "GPS RETURN" light is solid on. After 5 seconds, release step 2) button. "GPS RETURN" light is off. Switch off radio power.

### **Radio BIND With Boat**

- 1) Radio and boat are power off status.
- 2) Press "ST/L" button and hold.
- 3) Switch on radio power, until "GPS ON" light flash, release step 2) button.
- 4) Connect boat battery, "BATT.INDICATOR", "RX" lights are solid on. Now you have BIND radio with boat.

### **ESC Calibrate**

- 1) Pull throttle trigger till the end and hold, switch on Radio, "TX ON" light is solid on.
- 2) Connect boat battery.
- 3) You will hear below groups of sound:  
Four group sound "DI-DI,DI-DI,DI-DI, DI-DI"  
Four group sound "DE-DE-DE-DE, DE-DE-DE-DE,(Release throttle trigger between 2nd sound and 3rd sound) DE-DE-DE-DE, DE-DE-DE-DE"  
Release trigger between 2nd and 3rd sound. "BATT.INDICATOR", "RX" lights are solid on. Then you will hear the correct sound of ESC finish calibration "DE DEEE". If the ESC don't make sound like "DE DEEE". you need to do again the ESC calibration.

### **IMPORTANT:**

- 3.1) If you release trigger between 1st and 2nd sound, or between 3rd and 4th sound. You may also get the correct ESC calibration sound DE DEEE. Please release trigger between 2nd and 3rd sound as standard operation.
- 3.2) The only standard that shows ESC correctly calibrate is the sound "DE DEEE".

### **Motor Reverse**

If you have replaced a new brushless motor, after plug in three wires between motor and ESC, power on radio and boat, pull throttle trigger, if you can feel wind blow from propeller cover, you have correctly connect motor wires with ESC. If no wind blow, you need to exchange any two of the three wires connection to change the motor reverse rotating.

# Fishing Surfer Important Information

## GPS Home Coordinate

It is very vital that setup the GPS home coordinate before you drive out the boat to ocean to release bait and hook. GPS home coordinate is the important basis to achieve these GPS autopilot functions, such as one button return, four fishing spot marking, fail-safe and return. Refer to manual page 4 for details of setup GPS home coordinate.

## Maintenance

Saltwater is very corrosive. You must do follow maintenance steps at the end of your fishing trip. Otherwise, your fishing surfer boat maybe corrosive to be malfunction.

- 1) Flush motors in fresh water the end of the day. Tap transmitter trigger a few times.
- 2) Apply a few drops of "Approved Saltwater Oil" on the outside propeller Shafts, tap transmitter trigger a few times.
- 3) Apply a few drops of "Approved Saltwater Oil" on the rear lock pin set, bottom lock pin set. Rotate the radio knob to move the rear lock pin and bottom lock pin a few times.



## SPARE PART LIST

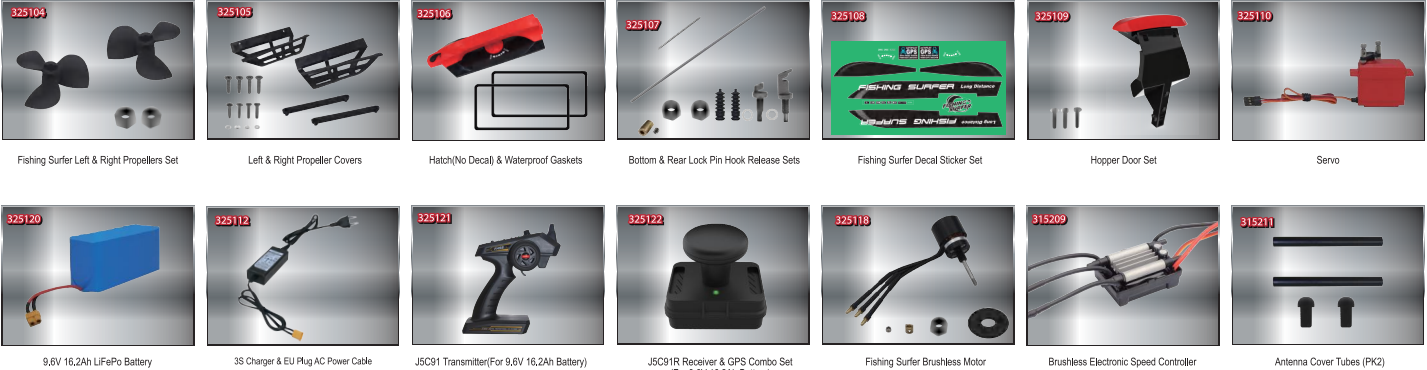

**FCC REQUIREMENT**

**FCC** This device complies with Part 15 of the FCC Rules. Operation is subject to the following two conditions: (1) This device may not cause harmful interference, and (2) This device must accept any interference received, including interference that may cause undesired operation.

CAUTION: Changes or modifications to this product not expressly approved by the party responsible for compliance may void the user's authority to operate the equipment.

**CHINA PATENT NO.: 201930618960.8**  
**HONG KONG PATENT NO.: PATENT PENDING**  
**NOT INTENDED FOR PERSONS UNDER 14 YEARS OF AGE, UNLESS CLOSELY SUPERVISED BY AN ADULT.**

**JOYSWAY HOBBY INTERNATIONAL LTD.**  
**ALL RIGHTS RESERVED.**  
**Made in China**